

SURFACE-MOUNT CONCEALED HINGE HES2S-140-A125 125° Opening

INSTRUCTION

HES
Hinge + Esprit®

Passed 300,000 open/close private cycle test



Black



Dark Grey



Light Grey



Closed



Back



With cover and plate removed

[Usage Image]

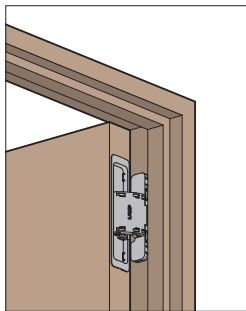

No mortising on the frame side is required.

[Opened to 90°] (without cover)

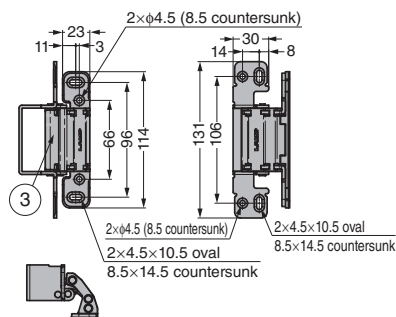

[Opened to 125°] (with cover)

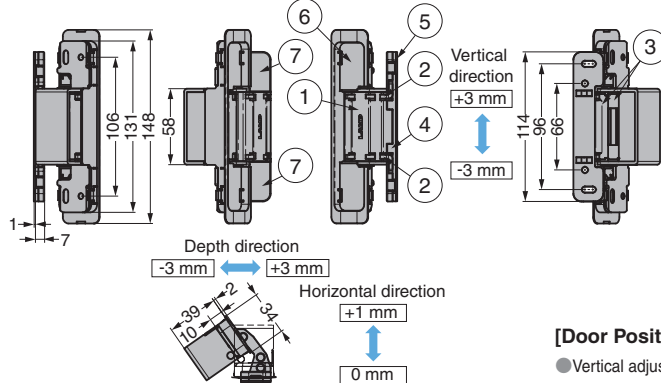

- Surface mount for door frame enables easy installation.
- 3-way adjustment function allows vertical, horizontal, and depth adjustment after hinge installed.

[Remarks]

- Use with a door stopper, etc. to prevent opening farther than 125°.
- The hinge cannot be divided between the door and frame.

[Parts included]

- Countersunk head tapping screw 4×20 (8 pcs/hinge) Steel
- Door side drilling/frame side mounting template

[Locus Chart]

Drill at the * mark in the figure (door/frame corner).

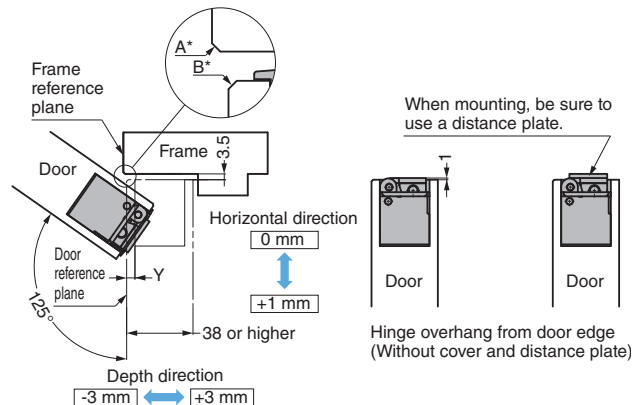

Y: Door Machining Margin	B: Door chamfering	A: Frame chamfering
4 or below	1 or higher	1 or higher
5		

[Cut Out Dimensions]

Drill pilot holes at the positions of the adjustment and locating screws.

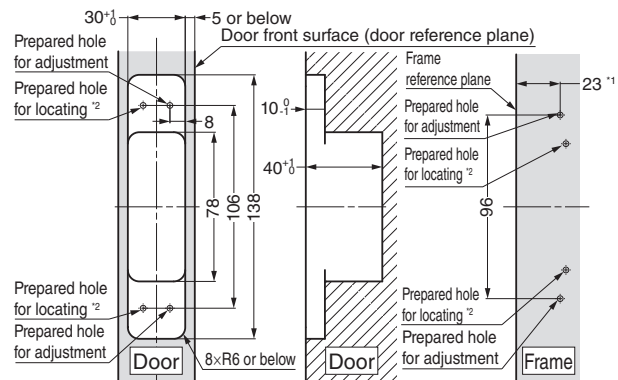
¹ When door machining margin is 5 mm.² The position of prepared hole for locating changes according to adjustment.

[Door Position Adjustment]

- Vertical adjustment (±3 mm)
- Horizontal adjustment (+1 mm)
- Depth adjustment (±3 mm)

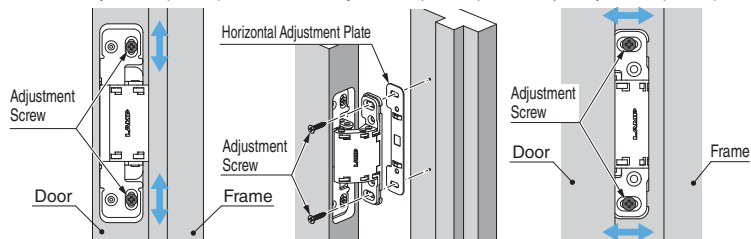

Adjust in the vertical/depth directions with oval hole screws and in the horizontal direction with the plate.

No.	Part Name	Material	Finish / Colour
①	Body	POM	Dark Grey, Light Grey, Black
②	Base Plate	SPCC	Nickel
③	Arm	Zinc Alloy (ZDC)	Chemical Treatment
④	Distance Plate	PBT	Dark Grey, Light Grey, Black
⑤	Horizontal Adjustment Plate	POM	
⑥	Socket Cover	ABS	
⑦	Base Plate Cover		

RdHS	CAD	Item Code	Item Name	Colour	Door Width	Door Height	Door Thickness	Door Weight kgf/2 pcs	Door Weight kgf/3 pcs	Opening Angle
●	●	170-053-252	HES2S-140-A125-DGR	Dark Grey	Max. 900	Max. 2700	Min. 38	50	65	125°
●	●	170-053-253	HES2S-140-A125-LGR	Light Grey						
—	●	170-050-758	HES2S-140-A125-BL	Black						