

Taps

Counter Mounted

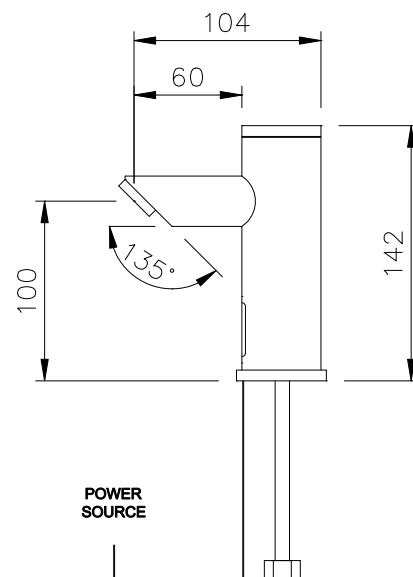
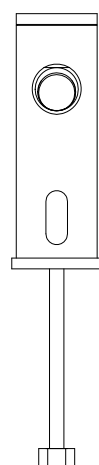
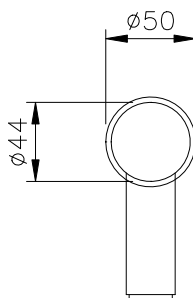

DB 200 / DB 225 Dolphin Blue Infrared Tap

- Touch Free Tap – for ultimate hygiene – prevents cross contamination
- Quality polished chrome plated brass or lacquered nickel plated brass finishes available
- Water Supply: Single inlet cold or pre-mixed – a TMV2 or TMV3 thermostatic mixing valve is recommended for premixed applications. For 2 inlet hot and cold feed see page 183
- Flow rate – 3.8 litres/minute (other flow rates available to special order – please enquire)
- Interchangeable STD M22/24 Neoperl Aerator insert
- Tap settings can be adjusted manually or by using remote control (DB51 – see page 188)
- Mandatory Hygiene Flush feature can be specified to combat Legionella – please specify at time of ordering
- **WRAS Approved Product**
 - 2 year manufacturer's warranty
 - Maximum water temperature 70°C
 - Operating pressure 0.5–8.0 bar (7–116 PSI)

Product Data

- H 142 x Ø 45 mm
- Projection 105mm
- Power Connections: tap male, power source female
- Counter hole Ø 28-34mm Min-max thickness 2-27mm
- 3/8" BSP water supply connector
- Power: Plug-in 9 volt transformers or 9 volt battery (with low battery warning) – for other power source options see page 190-191

Product Codes

Polished chrome finish

- Powered by 6 x AAA / 9v PP3 battery **DB 200C**
- Powered by 9v plug in transformer **DB 225C**

Brushed nickel finish

(designed to match brushed stainless steel)

- Powered by 6 x AAA / 9v PP3 battery **DB 200S**
- Powered by 9v plug in transformer **DB 225S**

Related items



DBL 400
page 180



WP 106
page 11



WP 208R
page 12



WP 112R
page 105



BC 2006
page 159