



Instruction of installation and Operation

For further information please contact us
T: 01977 809500

Unit 2 North Point Business Park, Eggborough, DN14 0JT

Prestige Behind Mirror Soap Dispenser Chrome With Bottom Access 1000ml



Thank you for purchasing our products and we will offer our best service to you sincerely
For the safety, please read & understand this instruction thoroughly before installation
and operation

Contents

Warnings	1		
Specifications	1	Installation of S. Sbracket	3
Before usage	1	Method of refill or replace soap.....	4
Name of spare parts	1	Testing and usage	4
Picture/Diagram of spare parts(Soap type).....	2	Care and cleaning	5
Picture/Diagram of spare parts(Foam type).....	3	Periodic maintenance.....	5
Installation location of the dispenser.....	3	Long-term suspension of usage	5

Warnings

For the safety and smooth operation, please pay attention on the following warnings.

- Please DON'T disassemble, repair or refit the products, because it might lead to electricity shock or product breakdown,unless stated otherwise.
- Please DON'T install the products in humid place, especially in bathroom or Sauna room
- Please DON'T strike the products, as this may damage the unit or cause soap leakage.
- Please DON T use the product in the place where freezing might be occurred.
- Please ensure that the power line separates from hot water line/tube.
- Please keep the detecting scope clear to avoid interference.
- The designated soap liquid is strongly recommended to be used.
- Please install the power socket/outlet in the place where water cannot be reached or sprayed

Specifications

Power supply	AC AC 100-240V	DC 4x1. 5V Alkaline batteries
Sensor detection range	5-150mm	
Ambient temperature	1-40℃	
Humidity	Max. 90RH	
Soap(Foam)volume	Soap-type:<1. 5ml;Foam-type:<38ml(Adjustable)	
Applicable soap viscosity	Soap-type:100-3800 cPs,Foam-type:0-100cPs	
Bottle volume	1000ml	

Before usage

1. Please read this instruction manual carefully and fix the products correctly.
2. We reserve the rights to upgrade products without a notice.
3. Please check whether the following spare parts completed or not.

Name of spare parts

--

Spare parts of Controller/host

Controller/host for soap-type

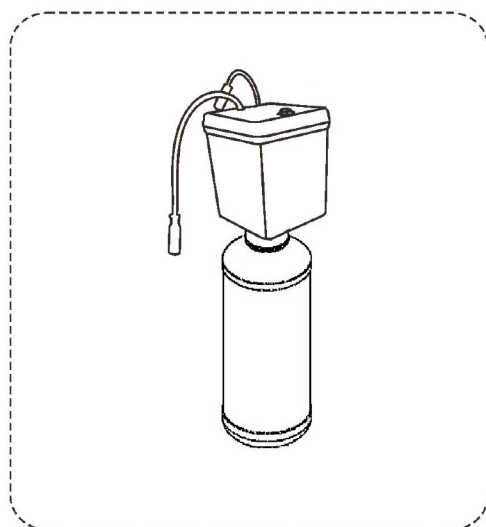

Controller/host for foam-type

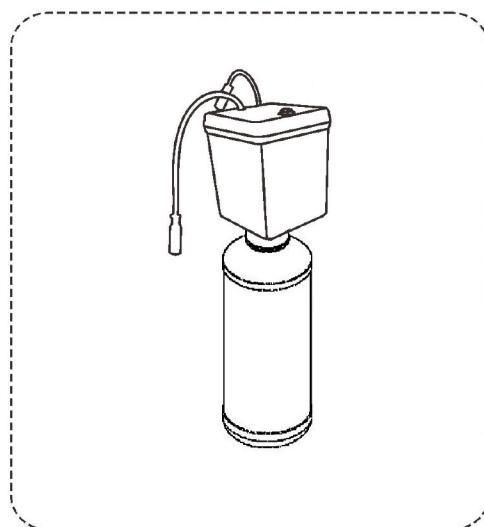

Spout&S. S bracket

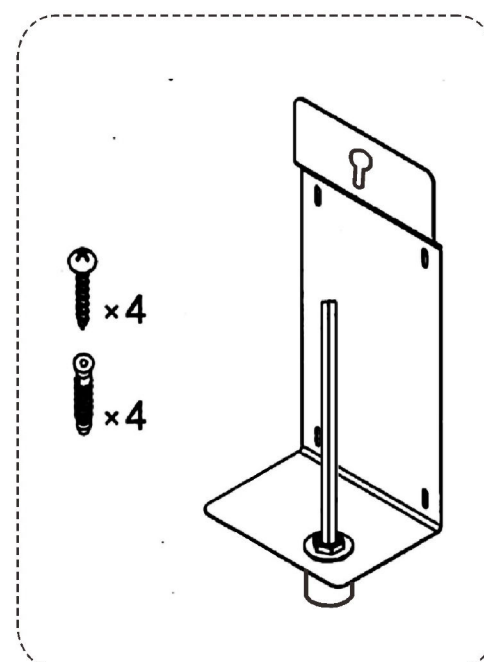

Spare parts of power supply

Battery Case (DC-type)

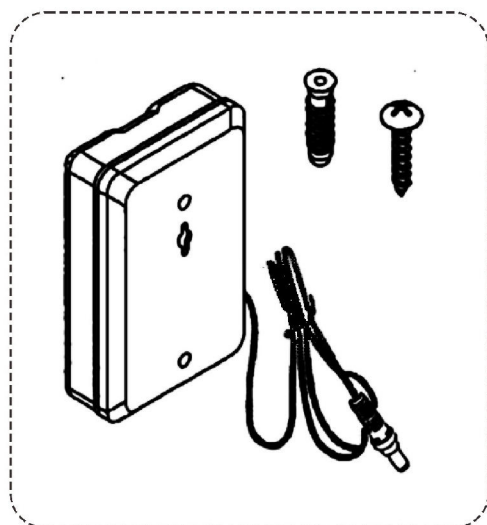

AC Adapter (AC-type)

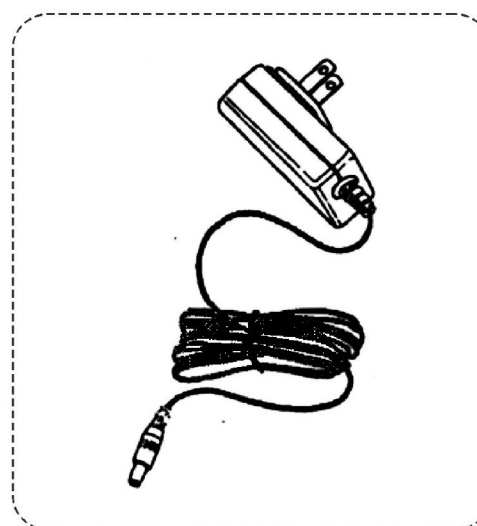

Note: 1.1. For the purchased spout, please take the real product as final, the above photos are for reference only.
2. As to the spare parts of power supply, please refer to the type of your purchased products.

Picture/Diagram of spare parts (Soap-type)

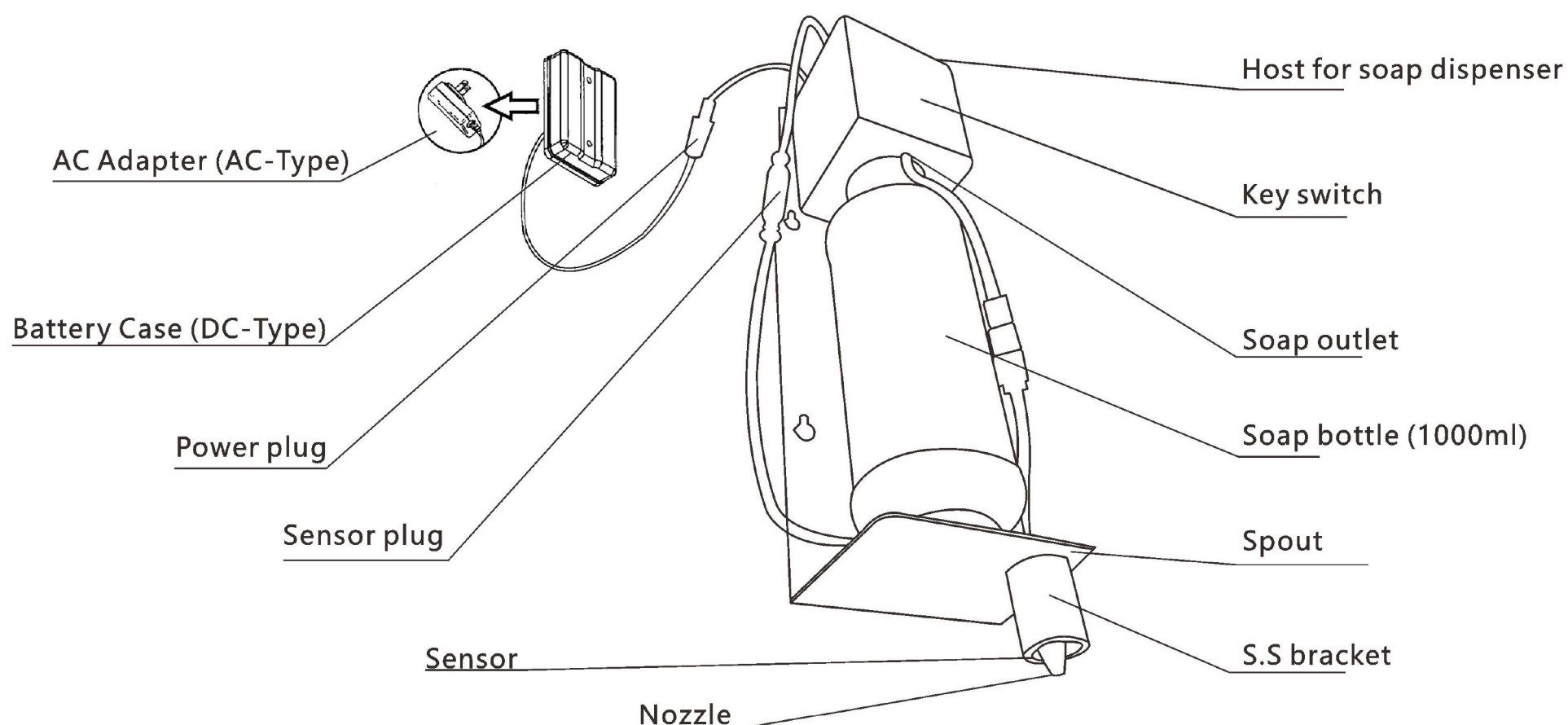

Picture/Diagram of spare parts (Foam-type)

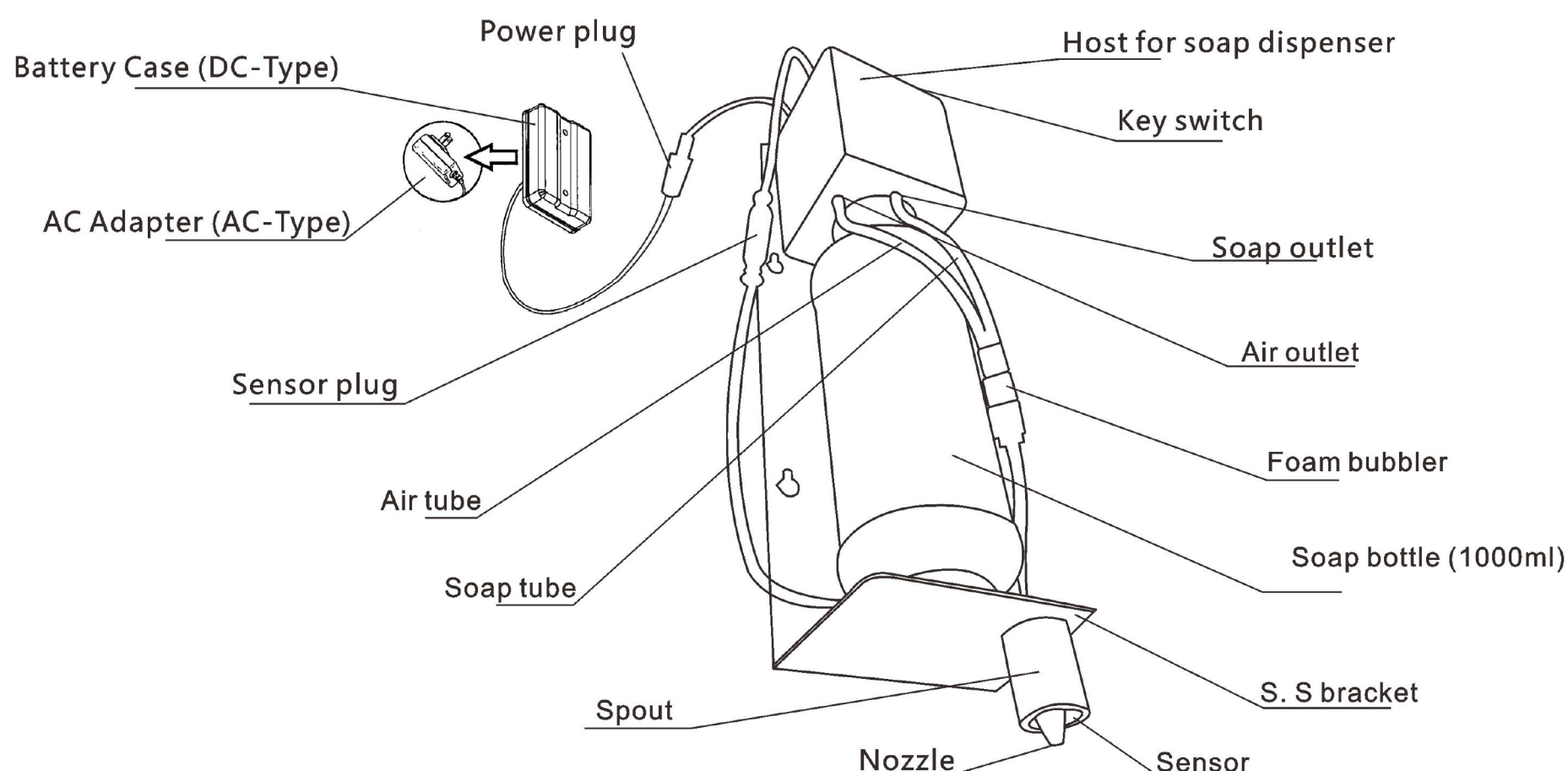

Installation location of the dispenser

1. Please ensure there is enough space behind mirror for the installation of this product.
2. If the length of soap tube or air tube is too long, they can be cut for suitable length.
3. Please keep enough space for refilling soap or replacing soap bottle.

Front view

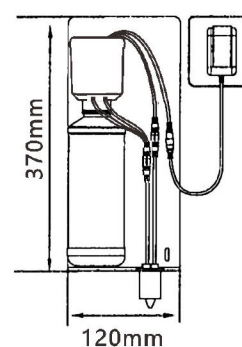

Side view

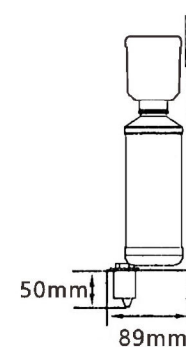

Note: The size of soap dispenser and foam dispenser are same.

Installation of S. S bracket

1. Please locate and mark the proposed location for the S. S bracket on mirror cabinet
2. Please drill proper holes in proposed location for S. S bracket.

Depth of hole 25mm

Diameter of hole

3mm (without rubber stopper)

7mm (with rubber stopper)

Note: Please ensure the S. S bracket is installed horizontally.

3. Please fix S. S bracket by self-tapping screws on the proposed location (the screw stopper can be used with self-tapping screws if needed)
4. Please put the host on S. S bracket (insert the hanging bracket located on the back of host into the hanging hole of S. S bracket).

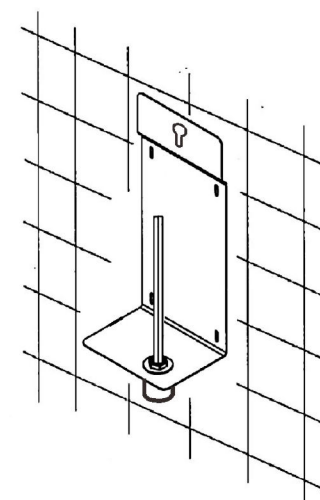
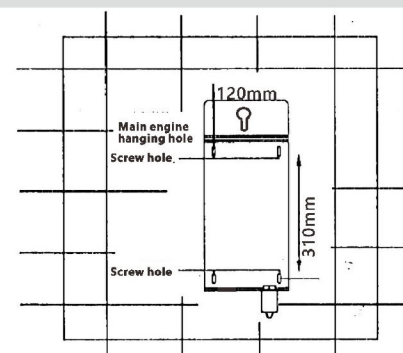
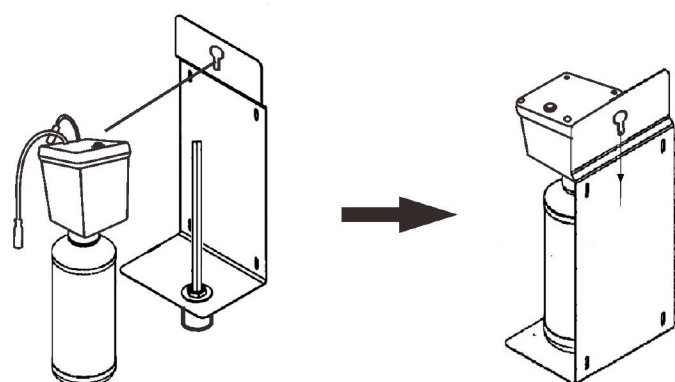

Note: The installation of host for soap dispenser and foam dispenser are the same.

Refill or replace soap

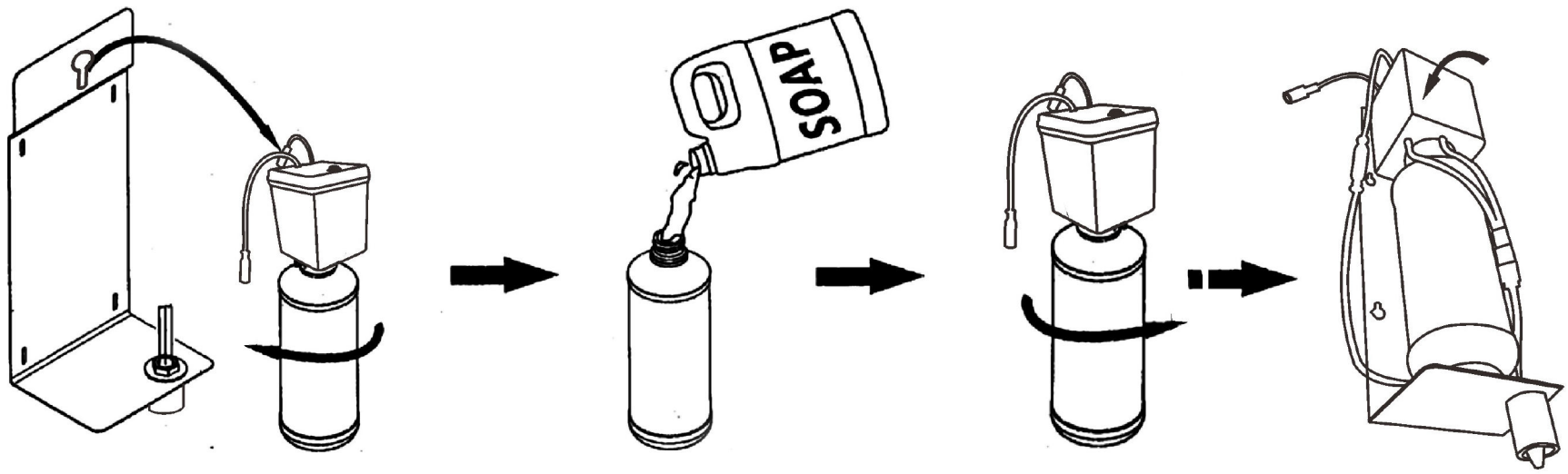

1. Take off the host from S. S bracket then twist off the bottle.
2 Refill the soap into the empty bottle (maximum 1000ml).

3. Put the full-loaded bottle into the host and fasten it.
4. Put the host onto the S S bracket and complete thereplacement of soap.

Testing and using

After completion of installation, please test theproduct according to the following instructions:

1. Connect power after filling the soap into the bottle.
2. Press the key switch until soap or foam spiting from the nozzle.
3. Put your hands under spout in appropriate distance and wait for fixed amount of soap or foam.

Note:please make sure there is no leakage on connection point of soap tube.

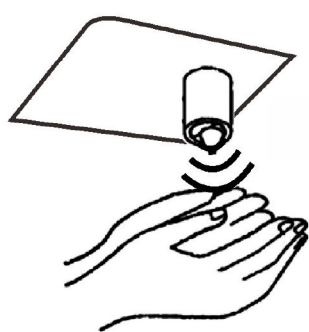
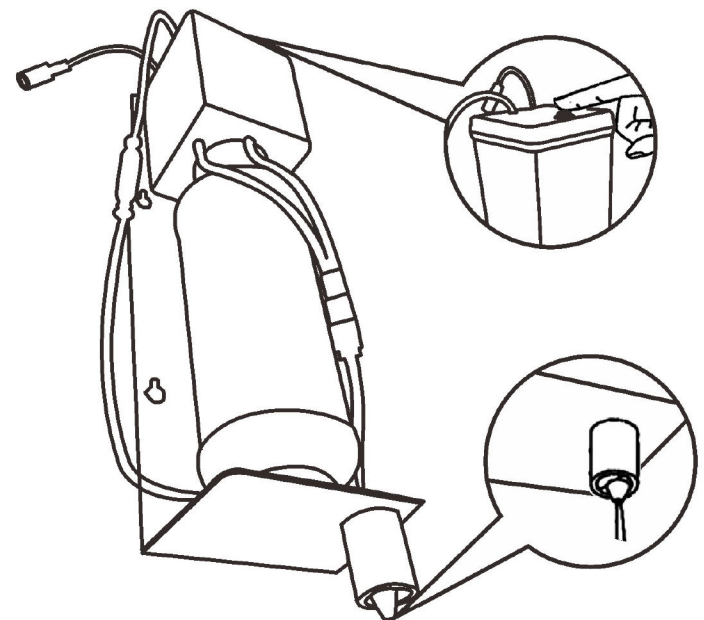

1. Put your hand under the nozzle of spout.

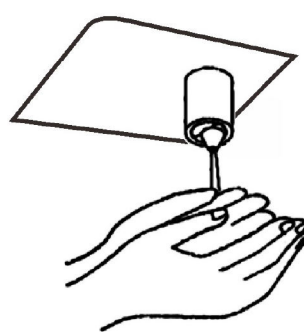

2. Soap or foam comes from nozzle.

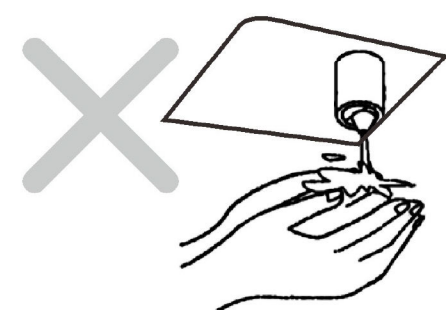

Caution: please do not put your hands too close tothe nozzle to avoid soap or foam splashing and prevent failure of the unit.

Care&cleaning

For light cleaning

Please use the soft cloth soaked with water and drying it and then to wipe off the stain affixed on spout & sensor cabinet.

For heavy-dirt cleaning

Please use the cloth soaked with right amount of neutral detergent to wipe off the stain and then clean by water. Please be careful during cleaning surrounding of sensor cabinet to avoid the scratching.

Please do not use the detergent which might do harm to the spout such as acid detergent, chlorine decolorizer & alkali detergent.

The following items are prohibited to adopt for cleaning the product.

The detergents contained abrasive grain, such as polishing powder.

Solvents such as paint and the solvent covered benzene.

Abrasive tools such as nylon brush/steel wool, etc.

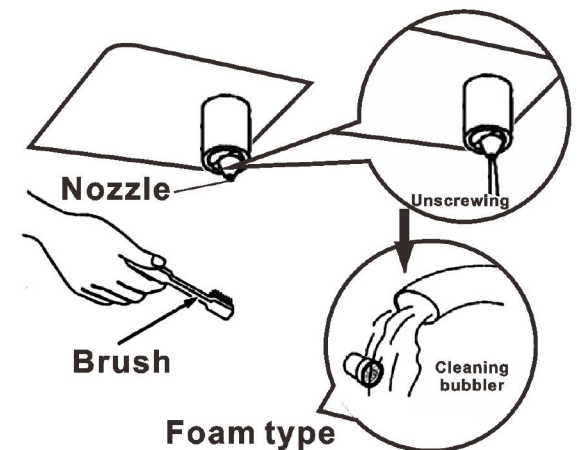
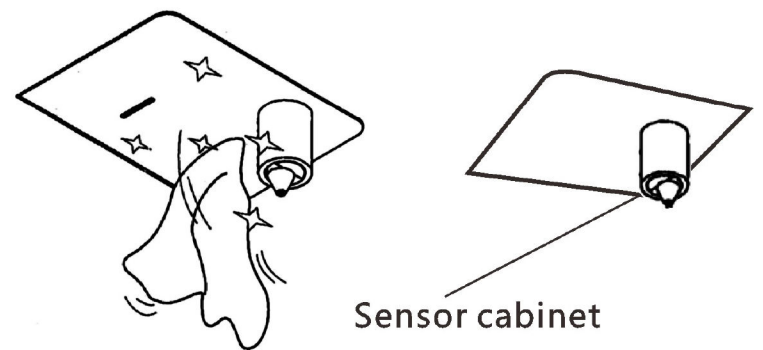

Cleaning the nozzle

Please use the soft brush to clean the nozzle.

Please open the nozzle by the Allen Wrench if the nozzle is blocked.

Please clean or replace the filter if there is block occurred in soap-type dispenser.

Cleaning of soap bottle

Please clean the soap bottle by clear water.

Cleaning of host system

If there is block or back-flow occurs on the host, please wash the soap bottle completely and then refill the clear water into the bottle, then press the key switch to clean the host.

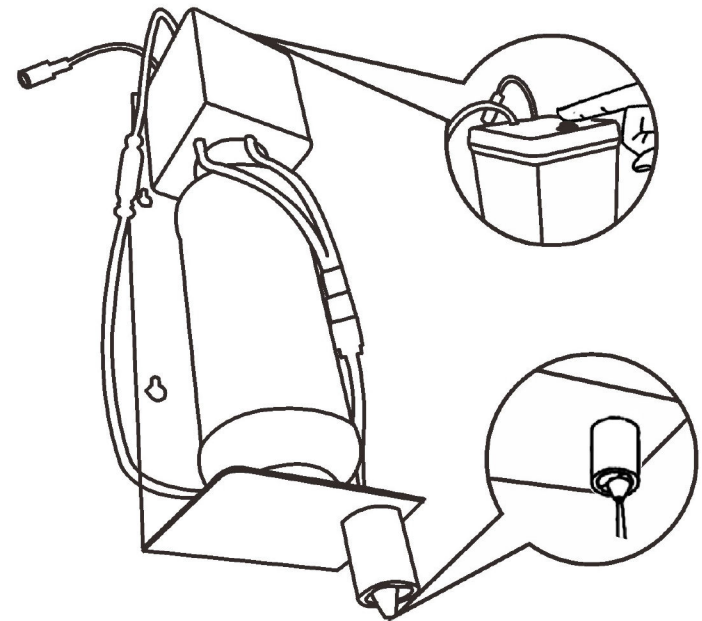

Periodic maintenance

Monthly maintenance:

Please check all the connection points whether there is soap or air leakage.

Please check all the connection points and fasten them accordingly and properly if needed.

When not in use for a long time

Please follow the below methods to undertake the cleaning if the dispenser is under long-term suspension of usage.

1. Please pull out all the soap and clean the soap bottle by clear water.
2. Please refill the soap bottle with clear water and complete the connection to the host.
3. Please press the key switch until the soap contained in soap tube is pumped out completely.
4. Please clean the soap bottle thoroughly and make it dry and then fix it onto the host, meanwhile, cut off the power (take the cell batteries out, if the power is DC type).