

# Dolphin Blue Electronic Taps



## Panel Mounted



DB 1400 page 243



DB 400/425 page 246



DBL 400/425 page 247

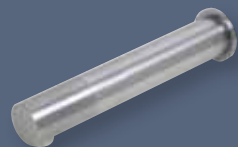

DBXL 400/425 page 248



Remote DB 51



### DBXL 400 / DBXL 425 – Dolphin Blue Panel Mounted Infrared Tap – Extra Long Series

- Touch Free Tap – for ultimate hygiene – prevents cross contamination
- Quality solid brass construction with the option of two durable finishes: polished chrome plating or lacquered brushed nickel plating
- Water Supply: Single inlet cold or pre-mixed – a TMV2 or TMV3 thermostatic mixing valve is recommended for premixed applications
- Flow rate – 3.8 litres/minute (other flow rates available to special order – please enquire)
- Flow time once user's hands are removed from the tap – 1 second (adjustable by using remote control DB51)
- 2 year manufacturer's warranty
- Interchangeable STD M22/24 Neoperl Aerator insert
- Power Source: Plug-in 9 Volt transformers or 9 Volt Battery (with low battery warning) – for other power source options see page 270-271
- Tap settings including optional hygiene flush can be adjusted by using remote control (DB51 – see page 268)
- Mandatory Hygiene Flush feature can be specified to combat Legionella
- **WRAS approved product**
- Maximum water temperature 70°C
- Operating pressure 0.5–8.0 bar (7–116 PSI)

Order code	Description	Finish	Power Connections		Panel Hole	Min-Max thickness
			Tap	Power Source		
DBXL 400C	6 x AA Battery	Polished Chrome Plating	Female	Male	Ø 23-40mm	10-30mm
DBXL 400S	6 x AA Battery	Brushed Nickel Plating	Female	Male	Ø 23-40mm	10-30mm
DBXL 425C	9v Transformer	Polished Chrome Plating	Female	Male	Ø 23-40mm	10-30mm
DBXL 425S	9v Transformer	Brushed Nickel Plating	Female	Male	Ø 23-40mm	10-30mm

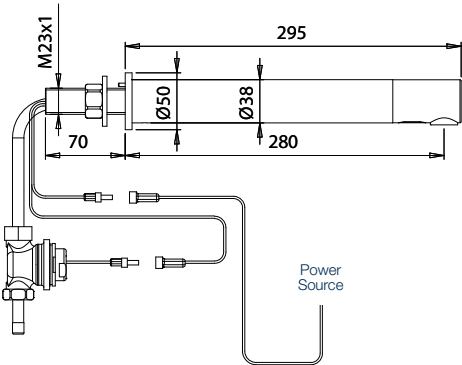

#### SPECIFICATION PHRASE

DBXL 400C Dolphin Blue Infrared Tap powered by battery

DBXL 400S Dolphin Blue Infrared Tap powered by battery

DBXL 425C Dolphin Blue Infrared Tap powered by 9v transformer

DBXL 425S Dolphin Blue Infrared Tap powered by 9v transformer